

AccuSort Series

Automatic Bottle Unscrambler/Orientators



Key Features:

- All AC Digital Motor Drives and Powered Moving Surfaces Utilize a Direct Drive System, Eliminating Belts, Clutches, Brakes, Gears and Chains.
- All contact parts are resistant to any flaking, chipping, scuffing, and will not cause any cosmetic damage to the containers during the orientation process
- Bulk Hopper
- Bulk Hopper Elevator is controlled with "On Demand" sensor
- Stainless Steel Construction
- Bottle Backup Sensor
- Quick and Easy Container changeover for use with multiple container types

Options:

- A high capacity 50 cubic foot basin
- A low-level alarm option
- Addition Change Parts
- Casters

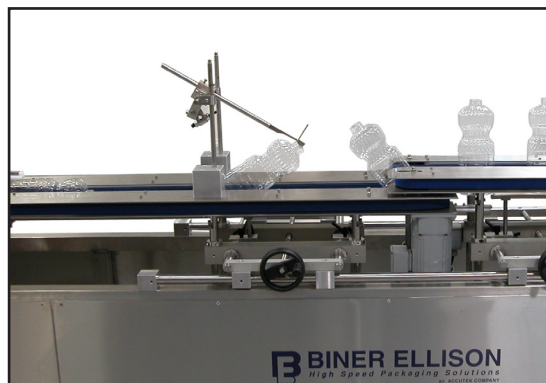
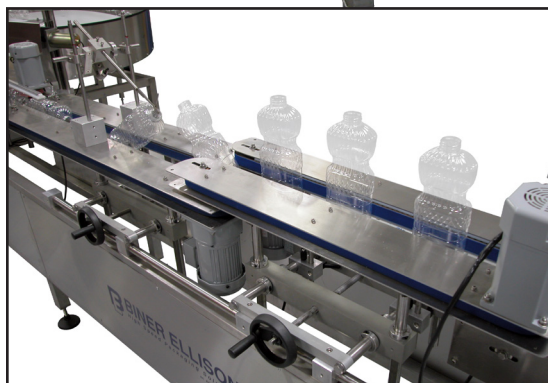

2980 Scott St, Vista CA 92081 • 760.734.4177 • Fax 760.734.4188
Email: sales@accutekpackaging.com • www.AccutekPackaging.com

ACCUTEK
Packaging Equipment Companies, Inc.

AccuSort Series

Automatic Bottle Unscrambler/Orientators

The AccuSort Series Bottle Unscrambler Orientators are manufactured and designed for long lasting durability and reliable operation. Constructed with high quality heavy duty stainless steel and aluminum. User friendly and variable speed controls on the Orientator, and Conveyor, make the AccuSort easy to adjust and able to handle different bottle sizes and shapes. The Orientator and conveyor can easily adjust to a variety of shapes and sizes from 1 oz. to 1 gallon containers. The machine can handle most container shapes including: round, square, rectangular, oval, tapered, F-style, etc. with few to no change parts.

Operation is as easy as loading the containers into the bulk supply hopper. The containers are then distributed into the rotary pre-feeder bowl automatically, and on demand. The Prefeeder rotates the containers single-file into the orientator that stands the containers upright and onto the conveyor. The AccuSort 100 Bottle Orientator is capable of speeds up to 250 containers per minute and the AccuSort 200 speeds up to 400 CPM. The bottle back up sensor will pause the Orientator if container flow upstream is paused.

Based on a heavy-duty stainless steel frame, food grade conveyor chain and container contact parts, the Automatic Bottle Unscramblers are food grade and durable. All contact parts are Stainless Steel or a FDA/USDA approved food grade material.

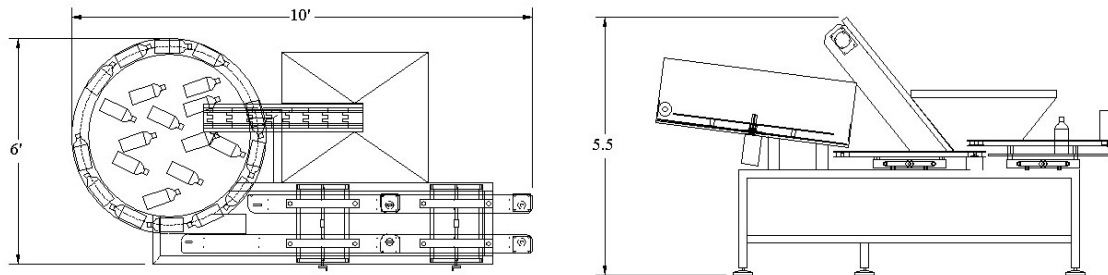

ACCUTEK
Packaging Equipment Companies, Inc.

AccuSort 100

Automatic Bottle Unscrambler Orientator



Unit Specifications

| | |
|---------------------------------|---------------------------------------------|
| Dimensions: | 108" x 72" x 66" (274 cm x 183 cm x 167 cm) |
| Weight: | 700 lbs. (317.5 kg) |
| Electrical Requirements: | 110 VAC - 5 AMP (220 VAC optional) |
| Air Requirements: | 90 PSI @ 6 CFM |

Output

| | |
|--------------------|------------------------|
| Sort Speed: | Up to 250 ¹ |
|--------------------|------------------------|



¹ Container dependant.

AccuSort 200

High Speed Automatic Bottle Unscrambler Orientator



Unit Specifications

| | |
|---------------------------------|---------------------------------------------|
| Dimensions: | 186" x 80" x 66" (472 cm x 203 cm x 167 cm) |
| Weight: | 1300 lbs. (499 kg) |
| Electrical Requirements: | 110 VAC - 15 AMP (220 VAC optional) |
| Air Requirements: | 90 PSI @ 6 CFM |

Output

| | |
|--------------------|------------------------|
| Sort Speed: | Up to 400 ¹ |
|--------------------|------------------------|



¹ Container dependant.